

Resolution No. 90-08

A RESOLUTION OF THE BOARD OF COUNTY COMMISSIONERS OF MASON COUNTY, ADOPTING THE OAKLAND BAY COUNTY PARK MASTER PLAN.

WHEREAS, Mason County is responsible for the maintenance, operation, and improvement of park facilities throughout the County; and

WHEREAS, Oakland Bay County Park is one of the facilities under the care and guidance of the County; and

WHEREAS, the Board of County Commissioners believe that it is necessary to plan for the development of park facilities to ensure public access, site conservation, address future demands, responsible use and stewardship of the park; and

WHEREAS, such a plan has been developed for Oakland Bay County Park which included the input and advice of interested community user groups; and

WHEREAS, a Resolution of the Board of County Commissioners is the appropriate mechanism to formalize this plan for implementation;

NOW THEREFORE, the Board of County Commissioners does hereby resolve as follows:

SECTION 1:

The Oakland Bay County Park Plan (Attachment A) as prepared by Robert Droll, ASLA is hereby adopted.

SECTION 2:

Mason County Parks Department is directed to implement the Oakland Bay County Park Master Plan consistent with available funding and Commission priorities.

ADOPTED by the Board of County Commissioners of Mason County, this 15<sup>th</sup> day of July, 2008.

BOARD OF COUNTY COMMISSIONERS  
MASON COUNTY, WASHINGTON

ATTEST:

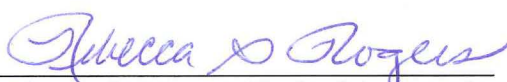
  
Rebecca S. Rogers, Clerk of the Board

  
Ross Gallagher, Commissioner

APPROVED AS TO FORM:

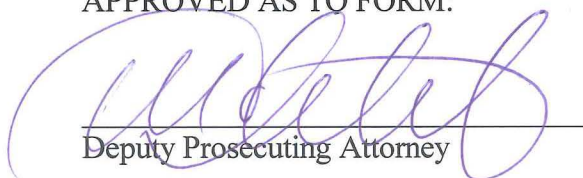
  
Deputy Prosecuting Attorney

  
Lynda Ring Erickson, Commissioner

  
Tim Sheldon, Chairperson

**Mason County Parks and Trails Capitol Land Trust  
Oakland Bay County Park**

**Environmental Education Plan**

- Oakland Bay Estuary**
- Overlook
  - Tideflats
  - Birdlife
  - Saltwater/Freshwater Interface

- Bridge Improvements**
- New Decking & Guardrails
  - Malaney Creek Geology, Fish & Ecology

- Overlook**
- Forest Regeneration

- Ridge Trail**
- 4' crushed rock loop trail 4,800 lf +/-

Park Vehicles & Vehicles with Handicapped Plates only beyond Trailhead

Blue Text represents environmental education storylines.

- Environmental Learning Center & Composting Toilet**
- The Edge Effect
  - Agarian Practices-Benefits to Wildlife
  - Benefits of Buffers

- Creek Trail**
- 4' crushed rock trail 4,300 lf +/-

- Overlook**
- at grade
  - Mixed Forest

- Trailhead**
- parking - 18 stalls, + 1 van accessible, + 1 bus stall
  - orientation / information kiosk
  - composting toilet
  - access control
  - Environmental Learning Shelter
  - Oakland Bay Geomorphology
  - Wildlife Use-Ravines & Ridges
  - Conservation Easement & Planning

Site Access Improvements

Pull-out  
2 Way, 1 Lane Road

Gate & Entrance Sign



Scale: 1"=100'

Mason County Parks and Trails Capitol Land Trust  
**Oakland Bay County Park**



Environmental Learning Shelter-Orientation Kiosk under canopy

Pull-Out

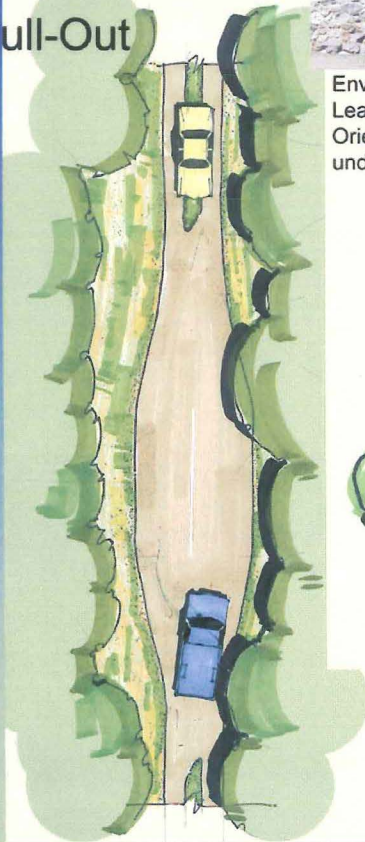

1 lane, 2 way road

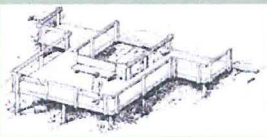

Overlook



4' Crushed Rock Trail

